

Key		
RVL--	R--...	Room Reference
RDS	R--...	Room Data Sheet Reference
DR	TOL_JFA_XX_XXX	Drawing Reference
WT	--	Wall Type
LN	--	Wall Lining Type
FT	--	Floor Type
CT	--	Ceiling Type

Proposed Wall Types

- WT-01 , K10.165
- WT-02 , k10.125
- WT-03 , K10.126
- WT-04 , K10.145
- WT-05 , K10.180
- WT-06 , K10.127

Proposed Wall Lining Types

- LN-01
- LN-02
- LN-03
- LN-04
- LN-05
- LN-06
- LN-07
- LN-08
- LN-09
- LN-10

A Refer to drawing TOL-JFA-01-XX-DW-A-5132 for further information

Proposed Floor Types

- FT-01
- FT-02
- FT-03
- FT-04
- FT-05-A
- FT-05-B
- FT-06
- FT-07
- FT-08
- FT-09
- FT-10
- FT-11
- FT-12
- FT-13

B Refer to drawing TOL-JFA-01-XX-DW-A-5130 for further information

Proposed Ceiling Types

- CT-01: Suspended plasterboard ceiling with acoustic plaster lining. K10.220
- CT-02: Suspended MR plasterboard ceiling. K10.221
- CT-03: Arched plasterboard ceiling with acoustic plaster lining. K10.230
- CT-04: Paint finish to masonry. M60.170
- CT-05: Brick cleaned and repointed. refer to heritage architect spec.
- CT-06: MR Plasterboard on timber rafters. K10.245

Notes  
To be read in conjunction with 3000 series.

Tender DRAFT

Existing Fabric

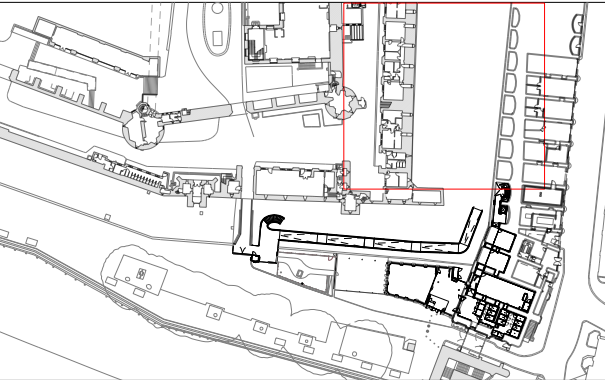

General Notes:

To be read in conjunction with Service Engineer, Structural Engineers and Heritage Architects information.

All demolition and proposed works are to be undertaken in adherence to SMC conditions and Listed Building Consent conditions.

Scale: 1:50

Jamie Fobert  
— Architects

Rochelle, 22 Club Row  
London E2 7EY  
T: +44 (0) 207 553 6560  
mail@jamiefobertarchitects.com

Copyright of Jamie Fobert Architects Ltd 2023

Unless indicated below, this drawing is for information only.  
Do not scale. Use figured dimensions only. All dimensions to be checked on site.

Issue/Revision	Date	Rev
Tender Draft	24 10 25	A

Project	The Tower of London
Subject	Rvtr: Prp ML (N) - Wall, Ceiling + Floor Finishes
Scale	1:50
Original Size	A1
Date	18 07 25
Drawing No.	TOL-JFA-01-UB-DW-A-1171